

Earth leakage protection and self-reclosing
RCCB with Self-reclosing system

REC2

Self-reclosing earth leakage relay



Description

REC2 is a 2 or 4-pole earth leakage switch associated to a compact motor and control set that enables the automatic and safe reclosure of the installation, provided that the leakage is not permanent. Output contact available in **REC2C** model

The earth leakage switch is reclosed automatically, in accordance with the work mode selected (switch on the front):

- **Time sequence mode:** after a switch trip, **REC2** will make 6 reclosing attempts, with a timer set at 10, 20, 30, 60, 120 and 600 s. If the set can not be reclosed, it will be blocked in a trip status until it is reset manually.
- **Insulation monitoring mode:** after the switch trip, **REC2** repeats the previous sequence, but it measures the presence of leakage current in the installation before carrying out the reset. **REC2** will only reclose when the insulation measurements are correct.

There are LEDs on the front part of the control module to indicate the operation status:

- Manual or automatic reclosure
- Reclosure mode selected
- Reclosing status
- Lock status

Drop-down window to activate/deactivate the automatic reclosure of the earth leakage switch.

Features

Protection	Earth Leakage
Class	Electromechanical, Class A
Measurement	Instantaneous value
Sensitivity $I_{\Delta n}$	30 mA or 300 mA (depending on the type)
Delay	Fixed at 20 ms
Test	With built-in button
Reset	Manual (front cover)
Associated circuit breaker	Built-in
I_n and no. of poles	I_n 40 A or 63 A, Poles 2 or 4 (depending on the type)
Circuit breaker control	Electromechanical relay
Reclosure	Earth Leakage
No. of reclosures	6
Time between reclosures	10, 20, 30, 60, 120, 600 s
Partial counter reset time	600 s (reset time after 30 s)
Reclosure cancellation	With the front cover
Features	
Nominal voltage	2 poles: 230 Vac 4 poles: 230 / 400 Vac
Auxiliary power supply	230 Vac, 50 ... 60 Hz
Operating temperature	-25 ... +55 °C
Hose features (only REC2C)	
Connector	JST BHR-02VS-1
Hose	YY 2x0.22, PVC 80 -300 V
Length	750 mm
Build features	
Fixing	DIN rail
Dimensions	2 poles: 5 modules (90 x 90 mm) 4 poles: 7 modules (125 x 90 mm)
Weight	2 poles: 560 g / 4 poles: 693 g
Degree of protection	IP 40
Standards	
IEC 61008-1, IEC 255-5	

Earth leakage protection and self-reclosing
Self-reclosing earth leakage switch

REC2

Self-reclosing earth leakage device



References

Class	Poles	I_n (A)	Sensitivity	Type	Code	With output contact	
						Type	Code
A	2	40	30 mA	REC2-2P-40-30	P26411	REC2C-2P-40-30	P26611
A	2	40	300 mA	REC2-2P-40-300	P26321	REC2C-2P-40-300	P26521
A	2	63	30 mA	REC2-2P-63-30	P26414	REC2C-2P-63-30	P26614
A	2	63	300 mA	REC2-2P-63-300	P26324	REC2C-2P-63-300	P26524
A	4	40	30 mA	REC2-4P-40-30	P26412	REC2C-4P-40-30	P26612
A	4	40	300 mA	REC2-4P-40-300	P26322	REC2C-4P-40-300	P26522
A	4	63	30 mA	REC2-4P-63-30	P26415	REC2C-4P-63-30	P26615
A	4	63	300 mA	REC2-4P-63-300	P26325	REC2C-4P-63-300	P26525

Dimensions

REC2 - 2 poles

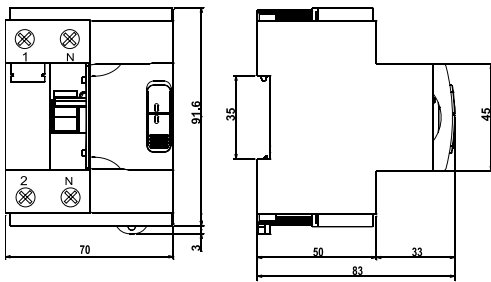

REC2 - 4 poles

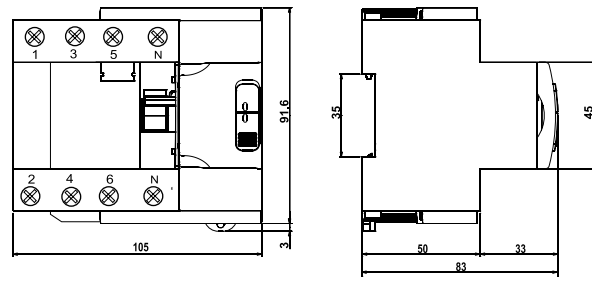

Connections

REC2

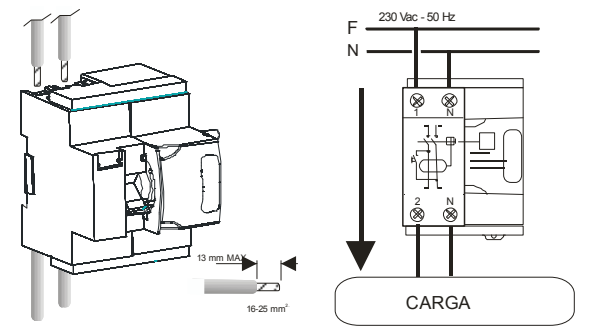

REC2C - output contact

